

Briton

1120 Series

Door controls



We are pleased to advise that Darley Aluminium NSW is now distributing the Briton 1120 Series door closers including the Briton 1120 Regular closer (1087-S) and Briton 1120 track arm closer (1087-T). The Briton 1120 Series is a non-handed, slimline closer designed to be used on commercial interior/exterior wooden and metal doors e.g. storeroom, office and toilet doors.

The 1120 is an adjustable 2-4 regular strength closer to suit a range of door sizes. Door closing is hydraulically controlled, with adjustable valve regulators, back check, closing and latching speed, and spring strength power control to give the desired closing speed.

The 1120 has a precision rack and pinion mechanism, and is easily mounted to the surface of door or the top jamb. Hold open and track arm versions also available.

KEY FEATURES

- Universal, fully reversible, non-handed door closer
- Closer body constructed from pressure die cast aluminium with steel rack and pinion
- Tested to 500,000 cycles
- Fully adjustable 2-4 strength regular arm & 1-3 strength track arm
- Factory set to strength 3
- Standard closer offers 3 installation options
 - Regular (pull side)
 - Top jamb (push side)
 - Parallel arm (push side)
- Independent adjustment valves for controlling backcheck, closing and latching speeds
- Available in sprayed silver, satin stainless steel and matte black finish
- The 10 year warranty provides specifiers and users with assured quality and performance
- Fire rated in accordance with Australian Standards, check with fire door manufacturer prior to installation

KEY FUNCTIONS

Regular	For applications where the door must fully close after each opening
Hold open	Suitable for doors where the door may need to be left in a hold open position. The hold open function can be set to hold open at a single point. Hold open closers can not be used on fire doors

SPECIFICATIONS

Door type	Timber or metal	Strength	Regular - 2-4 adjustable Track arm - 1-3 adjustable
Door size	See chart below	Options	Hold open arm Adaptor plate Parallel arm drop plate
Applications	Regular - pull side mount Parallel arm - push side mount Top jamb - push side mount	Finish	Sprayed Silver Satin stainless steel Matte black (only available as a complete unit including metal cover, track and arm, and all fixings)
Adjustment controls	Closing speed Latching speed Backcheck		

SELECTION CHART

Strength 1-6 adjustable	Maximum door leaf width	Door weight
Regular	850mm - 1100mm	40-80kg
Top jamb	850mm - 1100mm	40-120kg
Parallel arm (strength 2-5 adjustable)	850mm - 1100mm	40-100kg
Track arm (strength 1-4 adjustable)	750mm - 950mm	20-60kg

TRACK CLOSER

Product code: 1087-T
Closer is fixed to pull (hinge) side of door

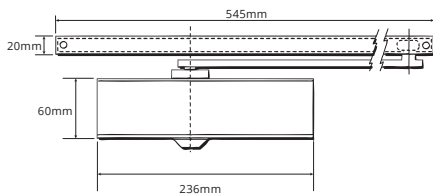

TOP JAM

Product code: 1087-S
Closer is fixed to top jamb on push (opposite to hinge) side of door

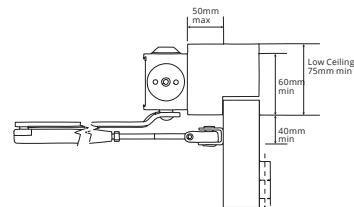

REGULAR CLOSER

Product code: 1087-S
Closer is fixed to pull (hinge) side of door

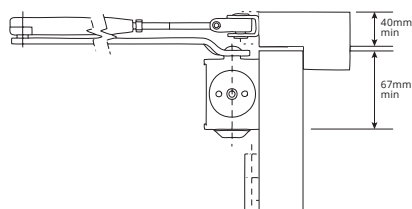

PARRALLEL ARM

Product code: 1087-S
Closer is fixed to the push (opposite to hinge) side of door

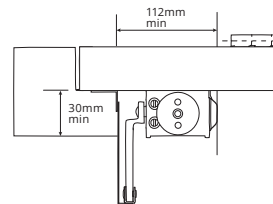

NSW

Tel: (02) 8887 2888
sales@darleyaluminium.com.au

VIC

Tel: (03) 9238 3888
salesvic@darleyaluminium.com.au

WA

Tel: (08) 9437 2999
saleswa@darleyaluminium.com.au

QLD

Tel: (07) 3287 1888
salesqld@darleyaluminium.com.au