

# Briton

## 1130 Series

Door controls



We are pleased to advise that Darley Aluminium NSW is now distributing the Briton 1130 Series door closers including the Briton 1130 Regular closer (1088-S) and Briton 1130 track arm closer (1088-T). The Briton 1130 Series is a non-handed, slimline closer designed to be used on commercial interior/exterior wooden and metal doors e.g. storeroom, office, and toilet doors.

The door closing function is hydraulically controlled, with adjustable valve regulators, back check, closing and latching speed, and spring strength power control to give the desired closing speed. The 1130 has a precision rack and pinion mechanism, and is easily mounted to the surface of door or the top jamb. Hold open and track arm versions also available.

### KEY FEATURES

- Universal, fully reversible, non-handed door closer
- Closer body constructed from pressure die cast aluminium with steel rack and pinion
- Tested to 500,000 cycles
- Fully adjustable 1-6 strength regular arm, 1-4 strength track arm
- Factory set to strength 3
- Standard closer offers 3 installation options
  - Regular (pull side)
  - Top jamb (push side)
  - Parallel arm (push side)
- Independent adjustment valves for controlling backcheck, closing and latching speeds
- Available in sprayed silver, satin stainless steel and matte black finish
- The 10 year warranty provides specifiers and users with assured quality and performance
- Fire rated in accordance with Australian Standards, check with fire door manufacturer prior to installation

## KEY FEATURES

<b>Regular</b>	For applications where the door must fully close after each opening
<b>Hold open</b>	Suitable for doors where the door may need to be left in a hold open position. The hold open function can be set to hold open at a single point. Hold open closers can not be used on fire doors

## SPECIFICATIONS

<b>Door type</b>	Timber or metal	<b>Strength</b>	Regular - 1-6 adjustable Track arm - 1-4 adjustable
<b>Door size</b>	See chart on below	<b>Options</b>	Hold open arm Adaptor plate Parallel arm drop plate
<b>Applications</b>	Regular - pull side mount Parallel arm - push side mount Top jamb - push side mount	<b>Finish</b>	Sprayed Silver Satin stainless steel Matte black (only available as a complete unit including metal cover, track and arm, and all fixings)
<b>Adjustment controls</b>	Closing speed Latching speed Backcheck Delayed action (NZ Standard)	<b>Warranty</b>	10 year mechanical

## SELECTION CHART

Strength 1-6 adjustable	Maximum door leaf width	Door weight
<b>Regular</b>	850mm - 1400mm	40-120kg
<b>Top jamb</b>	850mm - 1400mm	40-120kg
<b>Parallel arm (strength 2-5 adjustable)</b>	850mm - 1250mm	40-100kg
<b>Track arm (strength 1-4 adjustable)</b>	750mm - 1100mm	20-80kg

## TRACK CLOSER

**Product code: 1088-T**

Closer is fixed to pull (hinge) side of door

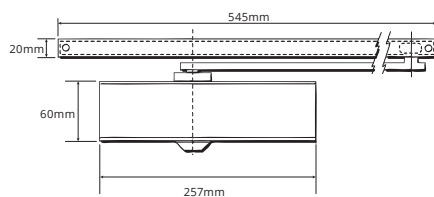

## TOP JAM

**Product code: 1088-S**

Closer is fixed to top jamb on push (opposite to hinge) side of door

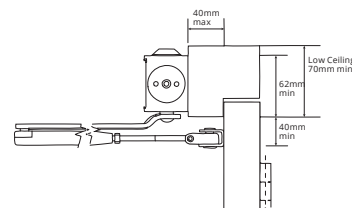

## REGULAR CLOSER

**Product code: 1088-S**

Closer is fixed to pull (hinge) side of door

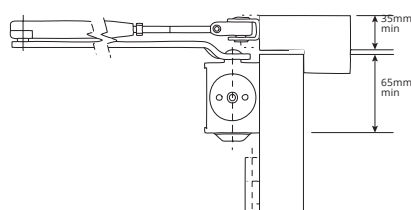

## PARRALLEL ARM

**Product code: 1088-S**

Closer is fixed to the push (opposite to hinge) side of door

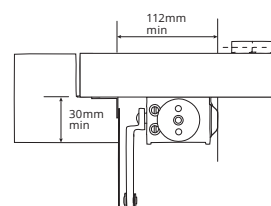

**NSW**  
Tel: (02) 8887 2888  
sales@darleyaluminium.com.au

**WA**  
Tel: (08) 9437 2999  
saleswa@darleyaluminium.com.au

**VIC**  
Tel: (03) 9238 3888  
salesvic@darleyaluminium.com.au

**QLD**  
Tel: (07) 3287 1888  
salesqld@darleyaluminium.com.au